

ZQRACING



ZQ RACING GAMING

OFFICE CHAIR

ASSEMBLY INSTRUCTION

Safety Information: the maximum load/limit of the chair is 150kg. Please follow the following step-by-step instructions while you assemble your new chair, we are not responsible for damage if these instructions are not carefully followed.

ZQRACING WARRANTY

All ZQRacing chairs structures (steel frames) come with life time warranty. All other parts come with a 2 year warranty (excluding natural wear of fabric: eg. PU leather and Vinyl). Please retain your prove of purchase for warranty purpose. For details, please visit <http://www.zqracing.com.au/terms-and-conditions/>

PARTS SERVICE:

We offer lifetime support in case of expired or non-warranty issues, which you can buy replacement parts of your chair at a fraction of a new chair cost. Please contact us for detail.
ZQRACING
ZQ PTY LTD

11/37 Mortimer Rd
Pictures are for demonstration only and may differ from your actual chair in appearance and features.
www.zqracing.com.au

info@zqracing.com.au

Main Box Contents

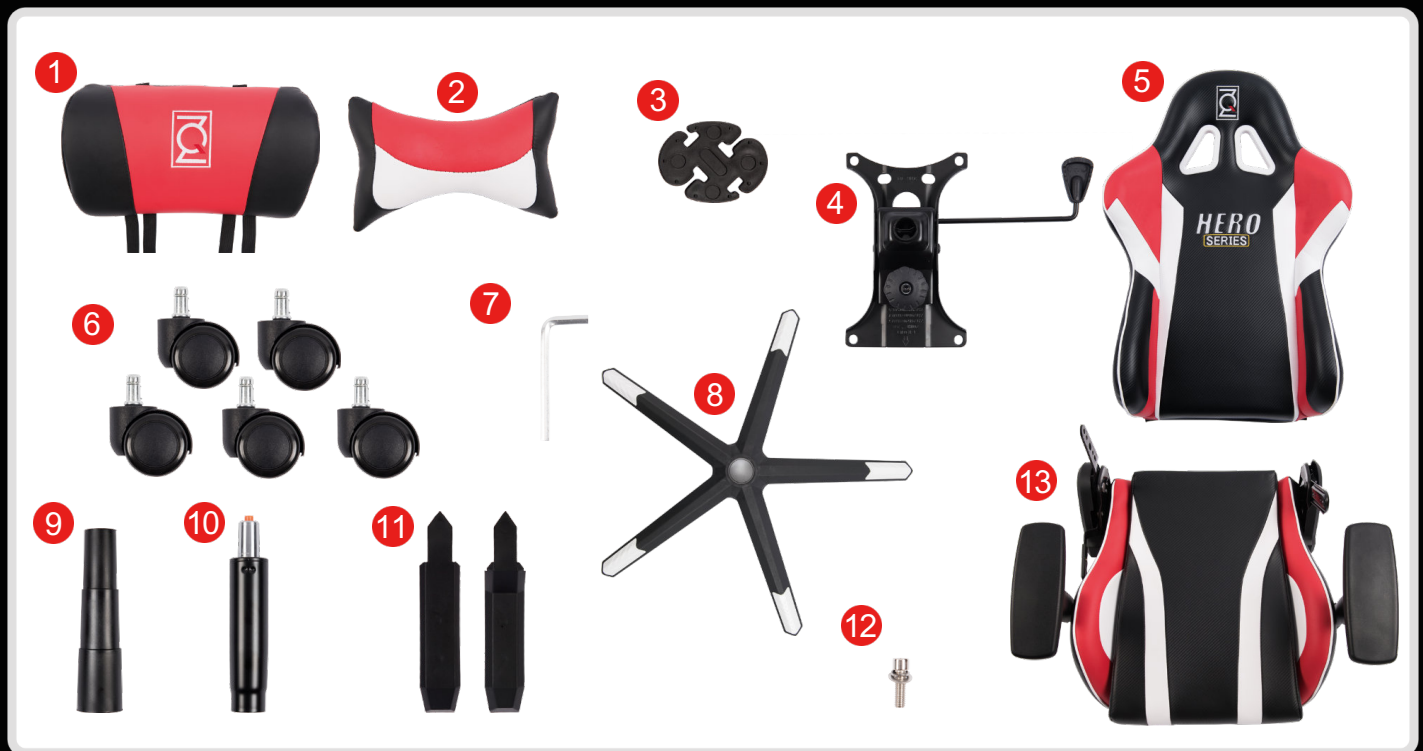

1. Lumbar support cushion

2. Head pillow

3. Head pillow elastic strips connector

4. Control mechanism

5. Backrest

6. Wheels

7. Hex key tool

8. Star base

9. Telescoping cover

10. Gas lift cylinder

11. Side covers

12. spare screw

13. Seat base

STEP.1

Remove the pre-assembled screws and washers from the backrest.



STEP.2

Remove the protective covers from the brackets of the seat base. Then position the backrest carefully between the brackets.



STEP.3

Insert and tighten all 4 screws (2 at each side) you prepared in step 1 by hand first. Then use the tool. Start with the two screws on the top of each side, then tighten the bottom screws.



STEP.4

Position the side cover with the screws aiming at the sockets. Push the side cover tight with a slight amount of pressure.



STEP.5

Repeat previous step on the other side.



STEP.6

Now place the backrest all the way to the back position. Flip the complete chair over, facing down. Then remove the 4 pre-mounted screws from the underside along with the washers.

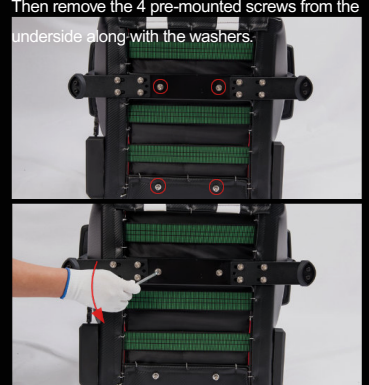

STEP.7

Place the control mechanism straight and tighten the screws from the last step with the tool. The hole to mount gas lift cylinder must face the front of the seat.

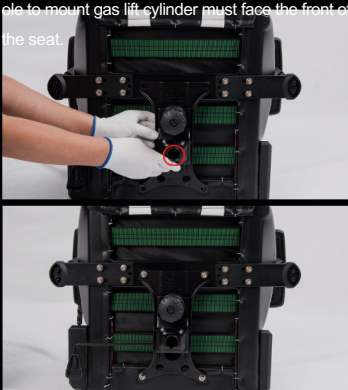

STEP.8

Place the gas lift cylinder with the telescoping cover into the hole at the base of the control mechanism.

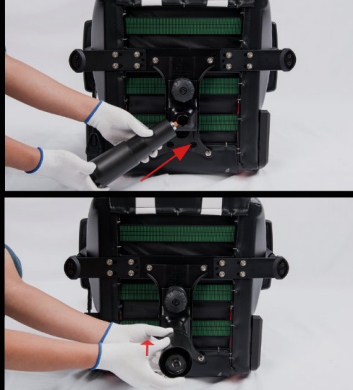

STEP.9

One by one, insert the wheels into the base. Then place the base onto the cylinder and firmly press into place.



STEP.10

Now turn the chair over into the upright position. You may place the head pillow over the backrest using the elastic strip and plastic connector provided.



STEP.11

Insert the straps of the lumbar support cushion through the slot at the base of the chair. Take the other ends of the straps and insert them through the large "belt" openings of the backrest. Now bring the ends together and snap into place.

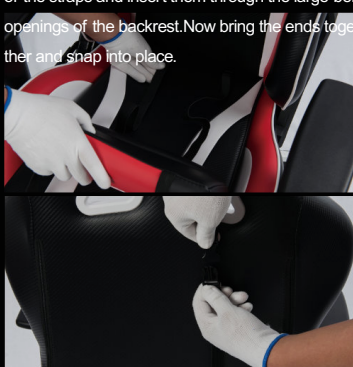

Website : <http://www.zqracing.com.au>